

# Type 3R Enclosures

## Weatherproof Screw Cover Gutter

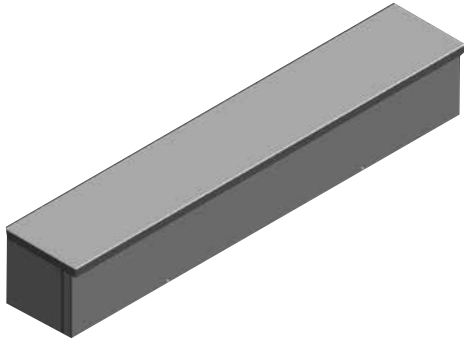

**APPLICATIONS** - To house electrical wiring where dust, dirt, oil and water are not serious problems.

**CONSTRUCTION** - Fabricated from 16 or 14 gauge galvanized steel. Enclosures feature:

- The removable cover is a slip-on style, fastened with screws located along the bottom edge. Mounting holes are located in back.

**FINISH** - Standard RAL 7035 texture polyester powder coat finish on interior and exterior of enclosures. Recoatable, smooth, white or ANSI-61 gray available at no charge. Standard RAL and custom match finishes available for an additional

charge, please contact Schaefer's Electrical Enclosures, Inc. for further assistance. All powder coat finishes applied over cleaned phosphatized surfaces.

**OPTIONS** - Schaefer's Electrical Enclosures, Inc. can modify standard enclosures or custom design enclosures according to your specifications. Sizes and many more options are available. Quotations upon request.

**INDUSTRY STANDARDS**

- UL 50 Listed
- Type 3R

Catalog Number	Enclosure Size		Gauge	Shpg. Wt.
	H x D x L	(inches)		
SPRSCG-4412	4 x 4 x 12		16	5
SPRSCG-4424	4 x 4 x 24		16	9
SPRSCG-4436	4 x 4 x 36		16	14
SPRSCG-4448	4 x 4 x 48		16	18
SPRSCG-4460	4 x 4 x 60		16	22
SPRSCG-4472	4 x 4 x 72		16	26
SPRSCG-6612	6 x 6 x 12		16	8
SPRSCG-6624	6 x 6 x 24		16	14
SPRSCG-6636	6 x 6 x 36		16	19
SPRSCG-6648	6 x 6 x 48		16	25
SPRSCG-6660	6 x 6 x 60		16	31
SPRSCG-6672	6 x 6 x 72		16	37
SPRSCG-8812	8 x 8 x 12		14	11
SPRSCG-8824	8 x 8 x 24		14	18
SPRSCG-8836	8 x 8 x 36		14	25
SPRSCG-8848	8 x 8 x 48		14	34
SPRSCG-8860	8 x 8 x 60		14	42
SPRSCG-8872	8 x 8 x 72		14	49

**SPRSCG**

