

# Floor Mount Enclosures

## Type 12 Two Door

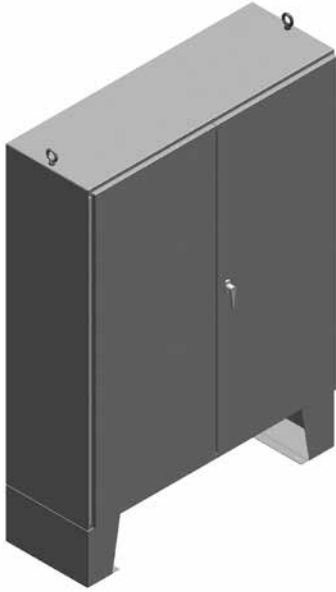

**APPLICATIONS** - Designed to provide protection for electrical controls, instruments, and terminals from dust, dripping liquids, dirt, and oil.

**CONSTRUCTION** - Fabricated from 10 and 12 gauge carbon steel, type 304 or 12 gauge type 316 stainless steel with continuous welded seams. Enclosure features:

- Overlapping doors are secured with continuous hinges with removable hinge pins and key locking handle with three point latching system
- Adhesive backed, oil resistant gasket applied to the doors
- 12-inch floor stands
- Print pocket
- Heavy-duty lifting eyes
- Ground studs installed inside cabinet and door
- Collar studs provided for mounting optional sub panels
- Body stiffeners for extra rigidity

**FINISH** - Standard RAL 7035 texture polyester powder coat finish on interior and exterior of enclosures. Recoatable, smooth, white or ANSI-61 gray available at no charge. Standard RAL and custom match finishes available for an additional charge, please contact Schaefer's Electrical Enclosures, Inc. for further assistance. All powder coat finishes applied over cleaned phosphatized surfaces. Carbon steel sub panels have a white polyester powder coat finish. Stainless Steel enclosures have a polished #4 finish.

**OPTIONS** - Schaefer's Electrical Enclosures, Inc. can modify standard enclosures or custom design enclosures according to your specifications. Holes, cutouts, louvers, sizes, materials, and many more options are available. Quotations upon request.

### INDUSTRY STANDARDS

- UL 50 Listed
- CUL 50 Listed
- Type 12

| Carbon Steel # | Catalog Number           |                          | Enclosure Size<br>H x W x D<br>(inches) | Shpg. Wt. | Sub Panel<br>Part Number | Sub Panel Size<br>H x W<br>(inches) |
|----------------|--------------------------|--------------------------|---|-----------|--------------------------|-------------------------------------|
|                | 304 Stainless<br>Steel # | 316 Stainless<br>Steel # |   |           |                          |                                     |
| SPN12D-54428   | SPN12DSS-54428           | SPN12DSS6-54428          | 54 x 42 x 8                             | 285       | SPDD-5442                | 50 x 38                             |
| SPN12D-60488   | SPN12DSS-60488           | SPN12DSS6-60488          | 60 x 48 x 8                             | 342       | SPDD-6048                | 56 x 44                             |
| SPN12D-604810  | SPN12DSS-604810          | SPN12DSS6-604810         | 60 x 48 x 10                            | 357       | SPDD-6048                | 56 x 44                             |
| SPN12D-606010  | SPN12DSS-606010          | SPN12DSS6-606010         | 60 x 60 x 10                            | 415       | SPDD-6060                | 56 x 56                             |
| SPN12D-726010  | SPN12DSS-726010          | SPN12DSS6-726010         | 72 x 60 x 10                            | 525       | SPDD-7260                | 68 x 56                             |
| SPN12D-727210  | SPN12DSS-727210          | SPN12DSS6-727210         | 72 x 72 x 10                            | 590       | SPDD-7272                | 68 x 68                             |
| SPN12D-604812  | SPN12DSS-604812          | SPN12DSS6-604812         | 60 x 48 x 12                            | 375       | SPDD-6048                | 56 x 44                             |
| SPN12D-606012  | SPN12DSS-606012          | SPN12DSS6-606012         | 60 x 60 x 12                            | 430       | SPDD-6060                | 56 x 56                             |
| SPN12D-726012  | SPN12DSS-726012          | SPN12DSS6-726012         | 72 x 60 x 12                            | 550       | SPDD-7260                | 68 x 56                             |
| SPN12D-727212  | SPN12DSS-727212          | SPN12DSS6-727212         | 72 x 72 x 12                            | 626       | SPDD-7272                | 68 x 68                             |
| SPN12D-604816  | SPN12DSS-604816          | SPN12DSS6-604816         | 60 x 48 x 16                            | 405       | SPDD-6048                | 56 x 44                             |
| SPN12D-604820  | SPN12DSS-604820          | SPN12DSS6-604820         | 60 x 48 x 20                            | 435       | SPDD-6048                | 56 x 44                             |
| SPN12D-604824  | SPN12DSS-604824          | SPN12DSS6-604824         | 60 x 48 x 24                            | 465       | SPDD-6048                | 56 x 44                             |
| SPN12D-606024  | SPN12DSS-606024          | SPN12DSS6-606024         | 60 x 60 x 24                            | 520       | SPDD-6060                | 56 x 56                             |
| SPN12D-726024  | SPN12DSS-726024          | SPN12DSS6-726024         | 72 x 60 x 24                            | 700       | SPDD-7260                | 68 x 56                             |
| SPN12D-727224  | SPN12DSS-727224          | SPN12DSS6-727224         | 72 x 72 x 24                            | 805       | SPDD-7272                | 68 x 68                             |

**NOTE:** Sub panels must be ordered separately. Reference page 124 for sub panel layout.

**SPN12D • SPN12DSS • SPN12DSS6**

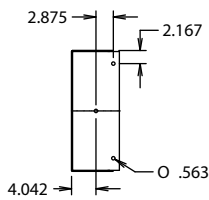
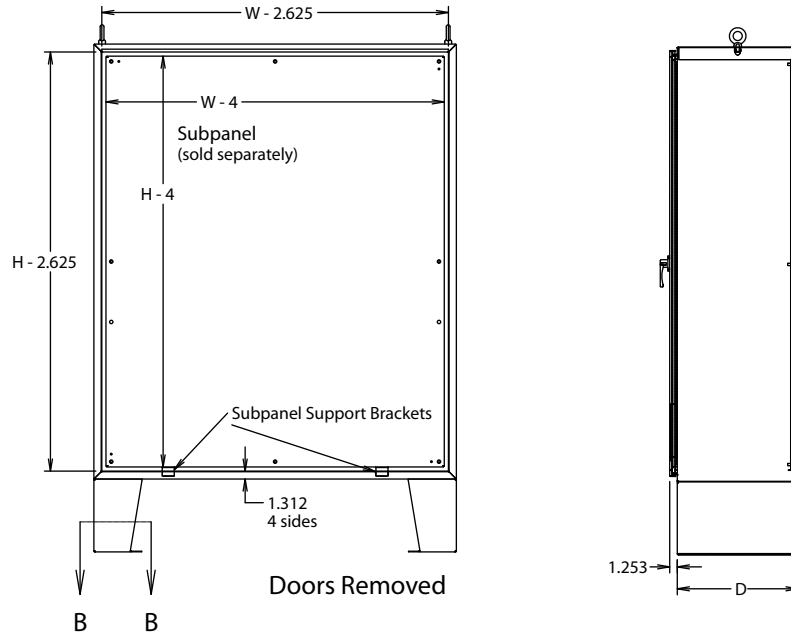

SECTION B-B

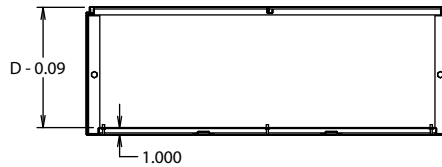

SECTION A-A

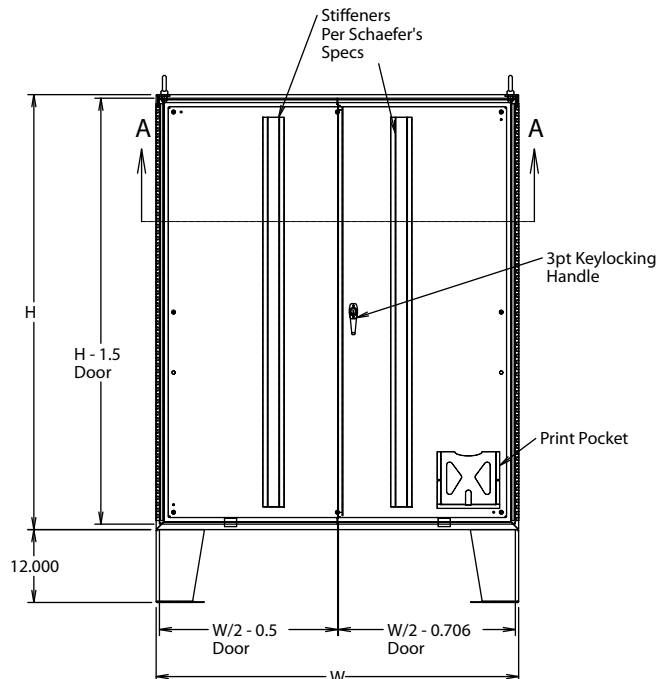

**NOTES:**

1. 9" x 9" Print pocket shipped inside enclosure.
2. 24" deep enclosures will receive 4 lifting eyebolts.